



32/20-24 Sorrell Street Parramatta NSW

2  1  1 

Conveniently located within minutes walk to Church Street restaurant/cafe precinct, Parramatta CBD, Rivercat, Rail & Bus Interchange and Westfield.

View : <https://www.moshav.com.au/5922704>

Features include:

- Tiled throughout
- Open-plan kitchen, dining and living room that spills out to the balcony, ideal for entertaining
- Stylish kitchen with stainless steel appliances, a gas cooktop and a dishwasher
- Main bedroom with built in robe
- Reverse Cycle split air conditioner, gas bayonette.
- Large oversized wrap around balcony
- Security video intercom & basement security parking, storage cage
- Just a short walk from the Parramatta CBD, Parramatta River and picturesque parklands



Mark Hahne
02 9188 5000

<https://www.moshav.com.au>

Moshav Realty is a boutique property management agency servicing the Eastern Suburbs, Eastern Beaches, CBD & a

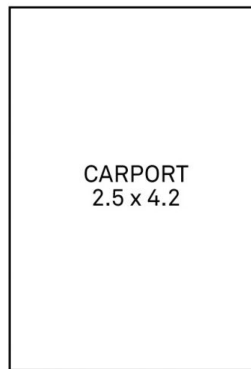

(NOT IN POSITION)

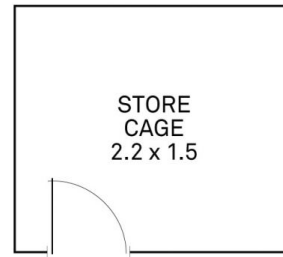

(NOT IN POSITION)

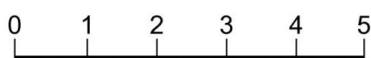
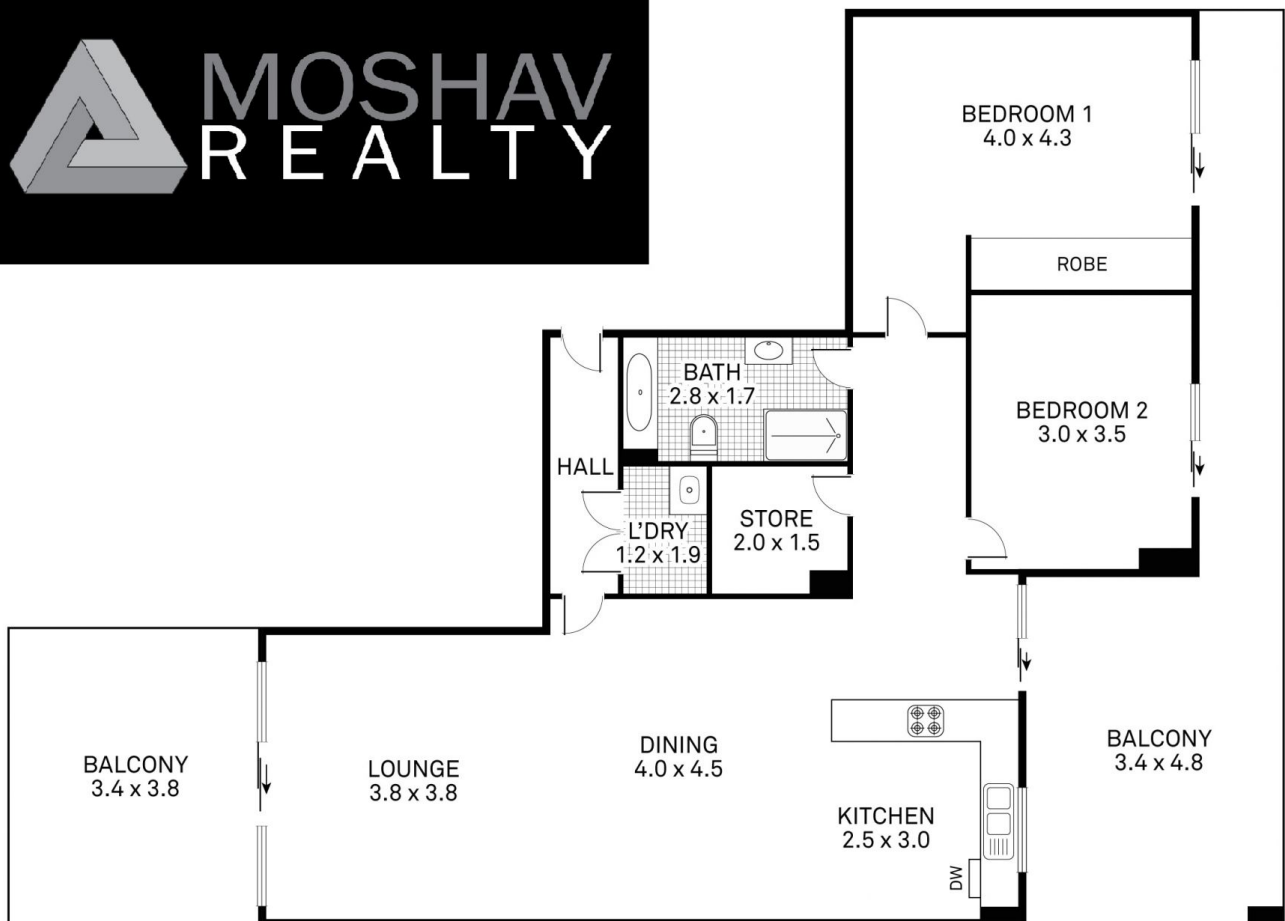

Scale in metres. Indicative only. Dimensions are approximate. All information contained herein is gathered from sources we believe to be reliable. However we cannot guarantee its accuracy and interested parties should rely on their own enquiries.

BALCONY
RESIDENCE
TOTAL AREA

- 38.4m²
- 92.5m²
- 130.9m²



32/20 Sorrell Street, Parramatta